

**PROJECT INFORMATION**

PROPOSED RC HUB TRUCKING FACILITY FOR:  
**CLASEN QUALITY CHOCOLATE**  
 MILTON PLANT • MILTON, WI 53563

PROFESSIONAL SEAL

**PRELIMINARY DATES**

APR. 8, 2022  
 APR. 29, 2022  
 JUNE 15, 2022  
 JUNE 28, 2022

**NOT FOR CONSTRUCTION**

**JOB NUMBER**

2220680

**SHEET NUMBER**

**A1.1**

**SYMBOLS LEGEND**

	SEE SHEET A4 SHEETS FOR WALL TYPES
	SEE SHEET A4 SHEETS FOR CURB DETAILS
	EXIT SIGNAGE
	FIRE EXTINGUISHER - SEE A5 SHEETS
	FIRE EXTINGUISHER w/ CABINET - SEE A5 SHEETS
	DRINKING FOUNTAIN - SEE PLUMBING PLANS
	HAND WASH - SEE PLUMBING PLANS
	HOSE STATION - SEE PLUMBING PLANS
	GUARD POST/GOAL POST DESIGNATION - SEE SHEET A6 SHEETS
	STUD WALL
	C.M.U. WALL
	(1) HOUR FIRE RATED
	(2) HOUR FIRE RATED
	(3) HOUR FIRE RATED
	(4) HOUR FIRE RATED
	NEW DOOR

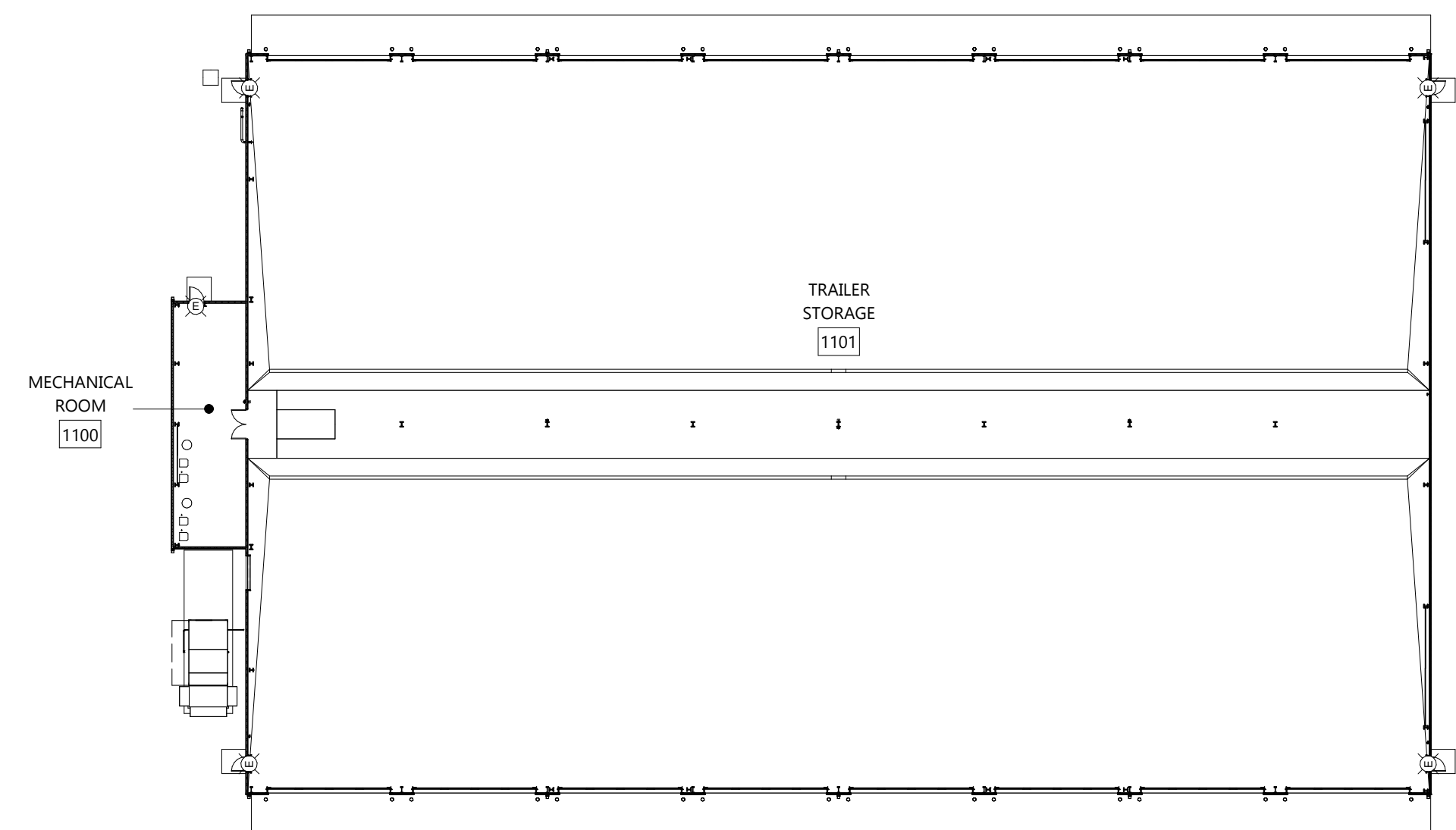
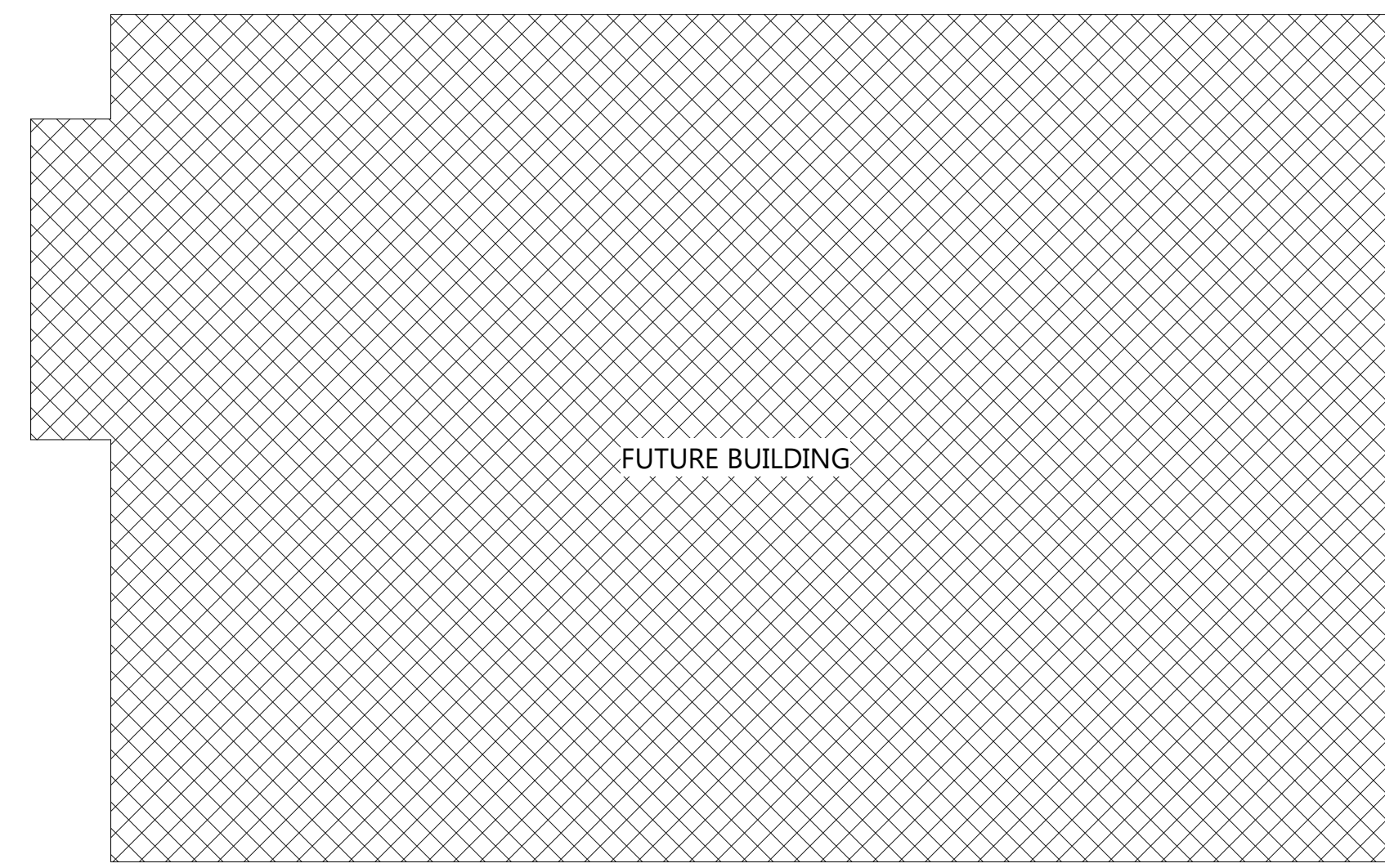
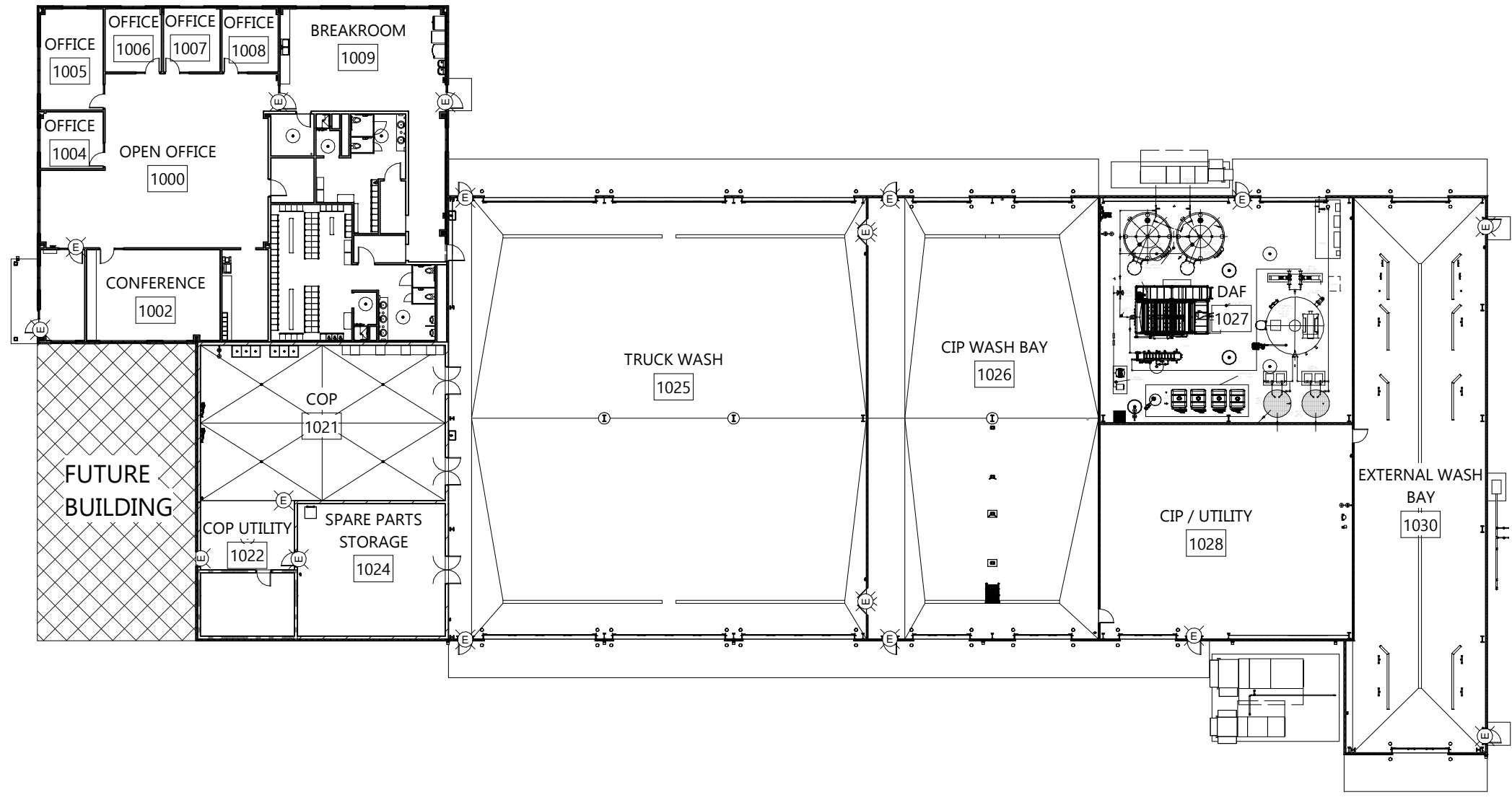

**OVERALL FIRST FLOOR PLAN**  
 SCALE: 1" = 30'-0"  
 NORTH

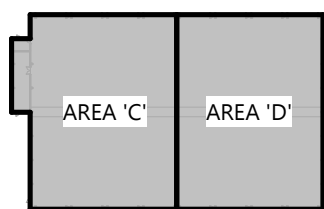
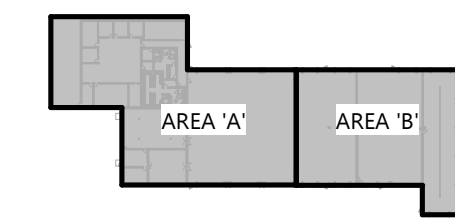

**KEY PLAN**  
 ARCHITECTURAL OVERALL FIRST FLOOR PLAN